

## **KYB NEWS**

---

### **Development of Steering Actuator for Driverless Dump Truck**

KYB has developed and started to mass-produce a steering actuator for autonomous driving in mining dump trucks.

This actuator was developed based on KYB's Electric Power Steering (EPS) technology, and therefore it has high performance, reliability and controllability regarding both autonomous and automatic driving. Furthermore, with a high degree of freedom in design to match the specifications of the vehicle joint, it is possible to adapt its shape to coexist with other parts and reach high performance.

This steering actuator has been adopted in the dump truck for autonomous driving system based on "EH5000AC-3" of Hitachi Construction Machinery Co., Ltd. and contributes to improve productivity and safety in mining sites.

Besides, the integrated brushless DC motor is equipped with an actuator itself provided with a controller that can be available for sale separately as a single unit. The motor can also be used in a variety of applications by customizing the magnet and the motor length which adapts them to the software and the required torque.



Dump truck for autonomous driving system  
(provided by Hitachi Construction Machinery Co., Ltd.)



Steering Actuator

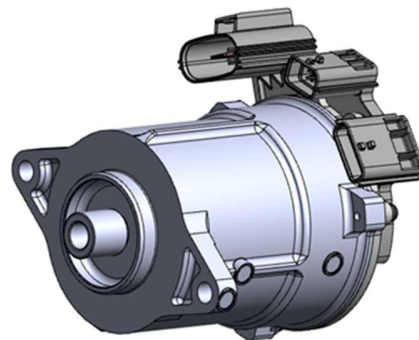

Brushless DC Motor